

Suction Filter

HF Series

Features and Handling

- Suction Filters are made from stainless steel mesh grade 125 micron reinforced with metal mesh and engineering resin for both ends. They are suitable for a wide variety of fluid system such as hydraulic systems. They can protect components in system, extend life and reduce breakdown for continuous equipment operation.

- The direction of flow on filters is from outside to inside. Filters can be cleaned by blowing compressed air or liquid through the mesh from the inside during maintenance.



Specification

Model	Flow L/min (USgsm)	Filteration Micron	Weight kg (lb)
HF-7	25 (7)	125	0.11 (0.24)
			0.11 (0.24)
HF-13	50 (13)		0.14 (0.31)
			0.14 (0.31)
HF-26	100 (26)		0.29 (0.64)
HF-53	200 (53)		0.32 (0.70)
HF-56	212 (56)		0.37 (0.81)
HF-92	350 (92)		0.65 (1.43)
HF-105	400 (105)		0.66 (1.45)

Suction Filter HF Series

Ordering Code

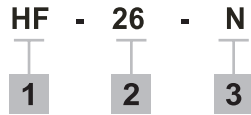

1. Model : HF
2. Flow (USgpm) : 7, 13, 26, 53, 56, 92, 105
3. Threaded connection
 P - BSPT
 N - NPT

Installation Dimension mm (inch)

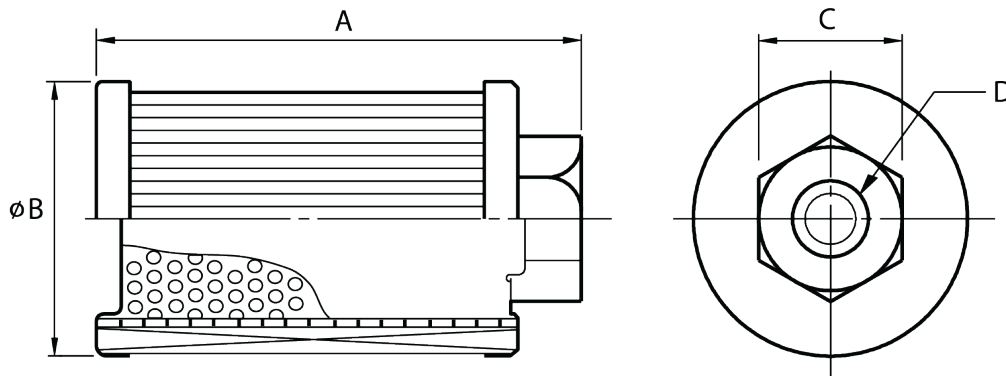

Model	Dimension mm (inch)			
	A	B	C	D (Thread)
HF-7	90 (3-1/2)	58 (2-1/4)	45 (1-3/4)	3/4" (NPT)
				1"
HF-13	157 (6-3/16)	58 (2-1/4)	45 (1-3/4)	3/4" (NPT)
				1"
HF-26	145 (5-11/16)	89 (3-1/2)	67 (2-5/8)	1-1/2"
HF-53	213 (8-3/8)	89 (3-1/2)	67 (2-5/8)	1-1/2"
HF-56	213 (8-3/8)	102 (4.0)	77 (3.0)	2"
HF-92	222 (8-3/4)	149 (5-7/8)	91 (3-5/8)	2-1/2"
HF-105	277 (10-7/8)	135 (5-5/16)	108 (4-1/4)	3"